

vtech[®]

Parent's Guide

4-In-1 Ride-On Fawn



VTech understands that a child's needs and abilities change as they grow and with that in mind we develop our toys to teach and entertain at just the right level...

vtech Baby

Toys that will stimulate their interest in different textures, sounds and colours

I am...

...responding to colours, sounds and textures

...understanding cause and effect

...learning to touch, reach, grasp, sit-up, crawl and toddle

Birth-36 months



Pre-School

Interactive toys to develop their imagination and encourage language development

I want...

...to get ready for school by starting to learn the alphabet and counting

...my learning to be as fun, easy and exciting as can be

...to show my creativity with drawing and music so my whole brain develops

3-6 years



Electronic Learning Computers

Cool, aspirational and inspiring computers for curriculum related learning

I need...

...challenging activities that can keep pace with my growing mind

...intelligent technology that adapts to my level of learning

...National Curriculum based content to support what I'm learning at school

4-10 years



To learn more about this and other VTech® products, visit www.vtech.co.uk

INTRODUCTION

Speed into learning with the **VTech® 4-In-1 Ride-On Fawn!**

This 4-in-1 grow with me fawn includes modes for ride-on play, push walker, scooter and a shape sorting wagon. Little ones can grow and develop with the fawn. The five light up buttons along with the Learn, Explore and Music modes introduce the animal characters and sounds, colours and play melodies and sing-along songs. The four shape sorting pieces add to the learning and provide little ones with the opportunity to problem solve.

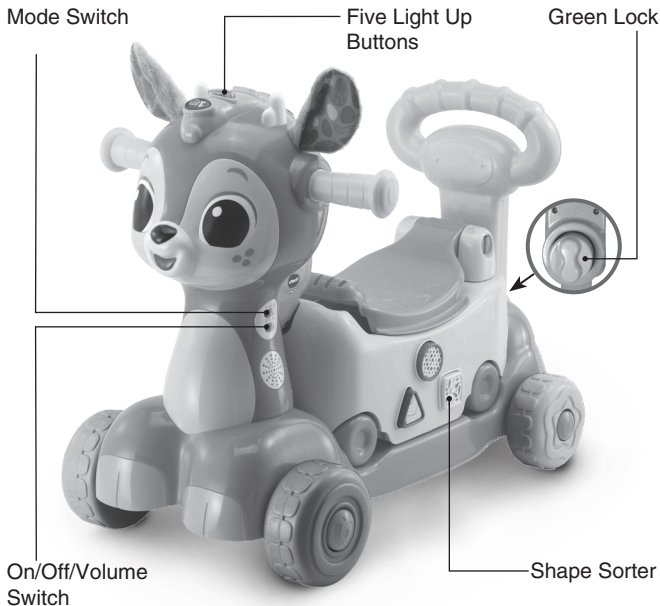

INCLUDED IN THE PACKAGE

- 4-In-1 Ride-On Fawn



Fawn Head



Wagon Body

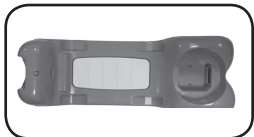

Scooter Base

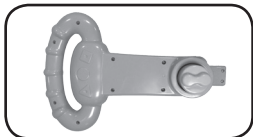

Walker Handle



2 Rear Wheels

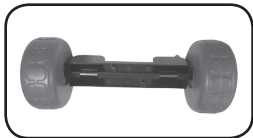

1 Set of Front Wheels



2 Handlebars



3 Shape Blocks

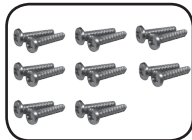

16 Screws

- Quick Start Guide

WARNING

All packing materials such as tape, plastic sheets, packaging locks, removable tags, cable ties, cords and packaging screws are not part of this toy, and should be discarded for your child's safety.

NOTE

Please save this Parent's Guide as it contains important information.

WARNING!

This toy should be used in a safe area e.g indoors, in a private garden, on level flat surfaces and away from any hazards such as cars, stairs, water etc.

Not for use on pavements or in traffic.

Adult supervision is advised.

Please help your child to sit properly on the seat and to use the toy correctly.

This toy should be used with caution to avoid falls or collisions that could cause injury to the user or third parties.

Warning! Protective equipment should be worn. Not to be used in traffic. 20 kg Max.

Please wear helmet, gloves, knee pads and elbow pads.



CAUTION:

Adult assembly required.

This package contains small screws.

For your child's safety, do not let your child play with the toy until it is fully assembled.

GETTING STARTED

BATTERY REMOVAL AND INSTALLATION

1. Make sure the unit is turned **Off**.
2. Find the battery cover on the back of the electronic activity panel. Use a screwdriver to loosen the screw and then open the battery cover.
3. If used batteries are present, remove these batteries from the unit by pulling up on one end of each battery.
4. Install 3 new AA batteries following the diagram inside the battery box. (For best performance, alkaline batteries or fully charged Ni-MH rechargeable batteries are recommended).
5. Replace the battery cover and tighten the screw to secure.

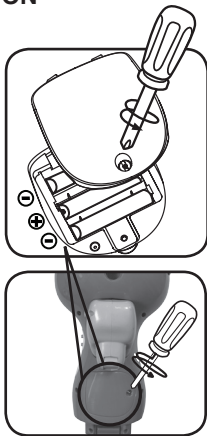

WARNING:

Adult assembly required for battery installation.
Keep batteries out of reach of children.

IMPORTANT: BATTERY INFORMATION

- Insert batteries with the correct polarity (+ and -).
- Do not mix old and new batteries.
- Do not mix alkaline, standard (carbon-zinc) or rechargeable batteries.
- Only batteries of the same or equivalent type as recommended are to be used.
- Do not short-circuit the supply terminals.
- Remove batteries during long periods of non-use.
- Remove exhausted batteries from the toy.
- Dispose of batteries safely. Do not dispose of batteries in fire.

RECHARGEABLE BATTERIES

- Remove rechargeable batteries from the toy before charging.
- Rechargeable batteries are only to be charged under adult supervision.
- Do not charge non-rechargeable batteries.

Disposal of batteries and product



The crossed-out wheellie bin symbols on products and batteries, or on their respective packaging, indicates they must not be disposed of in domestic waste as they contain substances that can be damaging to the environment and human health.

The chemical symbols Hg, Cd or Pb, where marked, indicate that the battery contains more than the specified value of mercury (Hg), cadmium (Cd) or lead (Pb) set out in the Batteries and Accumulators Regulation.



The solid bar indicates that the product was placed on the market after 13th August, 2005.

Help protect the environment by disposing of your product or batteries responsibly.

VTech® cares for the planet.

Care for the environment and give your toy a second life by disposing of it at a small electricals collection point so all its materials can be recycled.

In the UK:

Visit www.recyclenow.com to see a list of collection points near you.

In Australia & New Zealand:

Check with your local council for kerbside collections.

ASSEMBLY INSTRUCTIONS

With the **4-In-1 Ride-On Fawn**, safety comes first. To ensure your child's safety, adult assembly is required.

1. Attach the set of Front Wheels to the underside of the Scooter Base. Use six of the Screws to secure.



2. Attach the two Rear Wheels to the underside of the Scooter Base. Use eight of the Screws to secure.

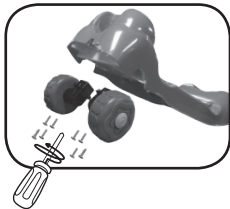

3. Insert the Handlebars into either side of the Fawn Head. You will hear the Handlebars click into place when inserted correctly. Once the Handlebars have been attached, they cannot be removed.

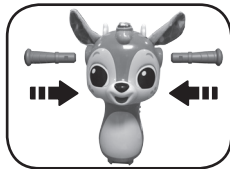

4. Push the Fawn Head onto the Scooter Base. You will hear the Fawn Head click into place when inserted correctly. Turn the Scooter Base over and use two of the Screws to secure.

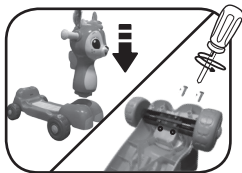

5. Attach the Wagon Body to the Scooter Base. You will hear the Wagon Body click into place when inserted correctly.



6. Insert the Walker Handle into the top of the Scooter Base, then push and turn the Green Lock clockwise to secure the Walker Handle. Use the Walker Handle to push or pull the fawn.

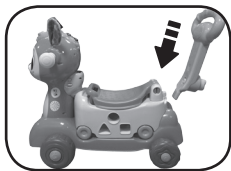

WARNING:

Not to be used by children over 36 months. Insufficient strength. Protective equipment should be worn. Not to be used in traffic. 20kg Max. Regularly check for signs of wear or tear on the snap in or locking devices. If damaged do not use until repaired or replaced. Only to be used under the direct supervision of a competent adult.

Convert from Ride-On Mode to Scooter Mode

1. Press the small green release button on the back of the Wagon Body while rotating the Green Lock on the Walker Handle anticlockwise, then pull the tab while removing the Wagon.

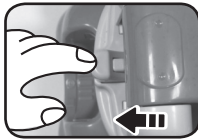
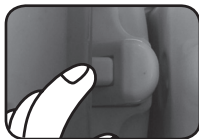

2. Insert the Walker Handle into the slot on the back of the Fawn Head. Turn the Green Lock clockwise to secure the Walker Handle. To remove the Walker Handle, press and hold the small button on the left side of the handle while turning the Green Lock anticlockwise.

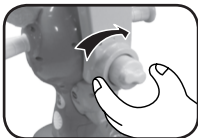
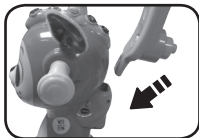

3. You have the option to attach the Wagon Body to the back of the Scooter. Insert the hinge on the front of the Wagon Body to the bottom of the Scooter Base. To disconnect the Wagon Body, pull on the hinge.

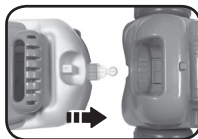

Convert from Ride-On Mode to Wagon Mode

Remove the Wagon Body from the Scooter Base and fold out the seat to make a pull handle.





WARNING:

Children should not sit or be transported inside the detachable wagon. The wagon is for storing and transporting shape blocks and other toys only.



PRODUCT FEATURES

1. On/Off/Volume Switch

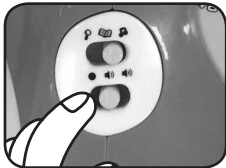
To turn the unit **On**, slide the **On/Off/Volume Switch** to the Low volume  or High volume  position. You will hear a fun phrase and a song. To turn the unit **Off**, slide the **On/Off/Volume Switch** to the **Off**  position.



2. Mode Switch

Choose a mode by sliding the **Mode Switch** to Explore Mode , Learning Mode  or Music Mode .

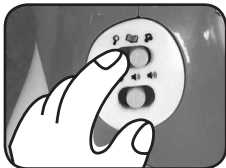

3. Automatic Shut-Off

To preserve battery life, the **4-In-1 Ride-On Fawn** will automatically shut off after approximately 90 seconds without input. The unit can be turned on again by pressing any button.

NOTE

If the unit powers down or if the light fades out during play, please install a new set of batteries.

ACTIVITIES

1. Light Up Buttons

Press the five **Light Up Buttons** to learn about animals through phrases and sounds in Explore mode. In Learning mode you will be introduced to colours and hear fun animal characteristics, and in Music mode you will hear songs and melodies. The lights will flash with the sound.

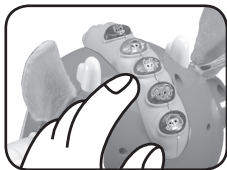

2. Motion Sensor

Roll the wheels on the scooter to activate the **Motion Sensor** and hear playful sounds, short phrases in Explore mode, and Learning mode, and hear songs and melodies in Music mode. In Music mode, activate the motion sensor to play melodies section by section. Stop rolling to hear the melody stop, or continue rolling to hear the full melody play. The lights will flash with the sound.

MELODIES

1. Bingo
2. A-Tisket, A-Tasket
3. Daring Young Man on the Flying Trapeze
4. Looby Loo
5. One Man Went to Mow a Meadow
6. Pease Porridge Hot
7. Skip to My Lou
8. Teddy Bears' Picnic
9. Toyland
10. Yankee Doodle

SONG LYRICS

Song 1

I can count, can you count too?
One, two, three, four, five.
Six, seven, eight, nine, ten. Oh yeah!

Song 2

Let's explore the big, big world,
Are you ready to zoom away?

Song 3

I'm a little fawn, I like to ride along.
Won't you sing, sing with me, as we ride along.

Song 4

Tiger is orange with black stripes, so many stripes.
Tiger has stripes from head to tail, from head to tail.

Song 5

Lion is so big and strong,
Running and bounding through the day.

Song 6

Llama's so cute and fluffy too.
Llama likes to chit chat all day with you.

Song 7

Elephant has two big ears, they flip and flop to and fro.
Elephant has two big ears, that flippity, floppity flip.

Song 8

Peek-a-boo, peek-a-boo!
Hedgehog likes to curl up in a ball and roll-roll-roll.

CARE & MAINTENANCE

1. Keep the unit clean by wiping it with a slightly damp cloth.
2. Keep the unit out of direct sunlight and away from any direct heat source.
3. Remove the batteries if the unit will not be in use for an extended period of time.
4. Do not drop the unit on hard surfaces and do not expose the unit to excess moisture.

TROUBLESHOOTING

If for some reason the program/activity stops working or malfunctions, please follow these steps:

1. Please turn the unit **Off**.
2. Interrupt the power supply by removing the batteries.
3. Let the unit stand for a few minutes, then replace the batteries.
4. Turn the unit **On**. The unit should now be ready to play with again.
5. If the product still does not work, install a brand new set of batteries.

If the problem persists, please contact our Consumer Services Department and a service representative will be happy to help.

CONSUMER SERVICES

Creating and developing **VTech®** products is accompanied by a responsibility that we at **VTech®** take very seriously. We make every effort to ensure the accuracy of the information, which forms the value of our products. However, errors sometimes can occur. It is important for you to know that we stand behind our products and encourage you to call our Consumer Services Department with any problems and/or suggestions that you might have. A service representative will be happy to help you.

UK Customers:

Phone: 0330 678 0149 (from UK) or +44 330 678 0149 (outside UK)
Website: www.vtech.co.uk/support

Australian Customers:

Phone: 1800 862 155
Website: support.vtech.com.au

NZ Customers:

Phone: 0800 400 785
Website: support.vtech.com.au

PRODUCT WARRANTY/ CONSUMER GUARANTEES

UK Customers:

Read our complete warranty policy online at vtech.co.uk/warranty.

Australian Customers:

VTech ELECTRONICS (AUSTRALIA) PTY LIMITED – CONSUMER GUARANTEES

Under the Australian Consumer Law, a number of consumer guarantees apply to goods and services supplied by VTech Electronics (Australia) Pty Limited. Please refer to vtech.com.au/consumerguarantees for further information.

**Visit our website for more
information about our products,
downloads, resources and more.**

www.vtech.co.uk
www.vtech.com.au

